



arch  daily

*the world's most visited architecture website*

# Nike New York Headquarters / WSDIA | WeShouldDoItAll + STUDIOS Architecture

[archdaily.com/877760/nike-new-york-headquarters-wsdia-weshoulddoitall](http://archdaily.com/877760/nike-new-york-headquarters-wsdia-weshoulddoitall)

November 14, 2017



© Floto+Warner

[+ 18](#)





- **Design**

STUDIOS Architecture, WSDIA | WeShouldDoItAll

- **Location**

855 6th Ave, New York, NY 10001, United States

- **Creative Directors**

WSDIA | WeShouldDoItAll, Michael Spoljaric (Nike)

- **Lead Architects**

STUDIOS Architecture

- **Area**

150000.0 ft<sup>2</sup>

- **Project Year**

2017

- **Photographs**

Floto+Warner

- **Manufacturers**

Kam Tang, Pink Sparrow, Lit, Miniwiz, Color X, Artisan Signcorp, More and More Ltd, Micah, Axiom



© Floto+Warner

*Text description provided by the architects.* Nike is in a New York state of mind upon completion of their new colossal office space in Midtown. WeShouldDoItAll (WSDIA) serves as creatives on environmental graphics.



© Floto+Warner

New York City is raw, never finished, and constantly reinventing itself. Nike is innovation, with an unrelenting drive to exceed expectations and inspire all athletes. So what do New York City and Nike have in common? Both are bold, vibrant and constantly breaking new ground. The connection is now further entrenched with Nike's East Coast headquarters complete.

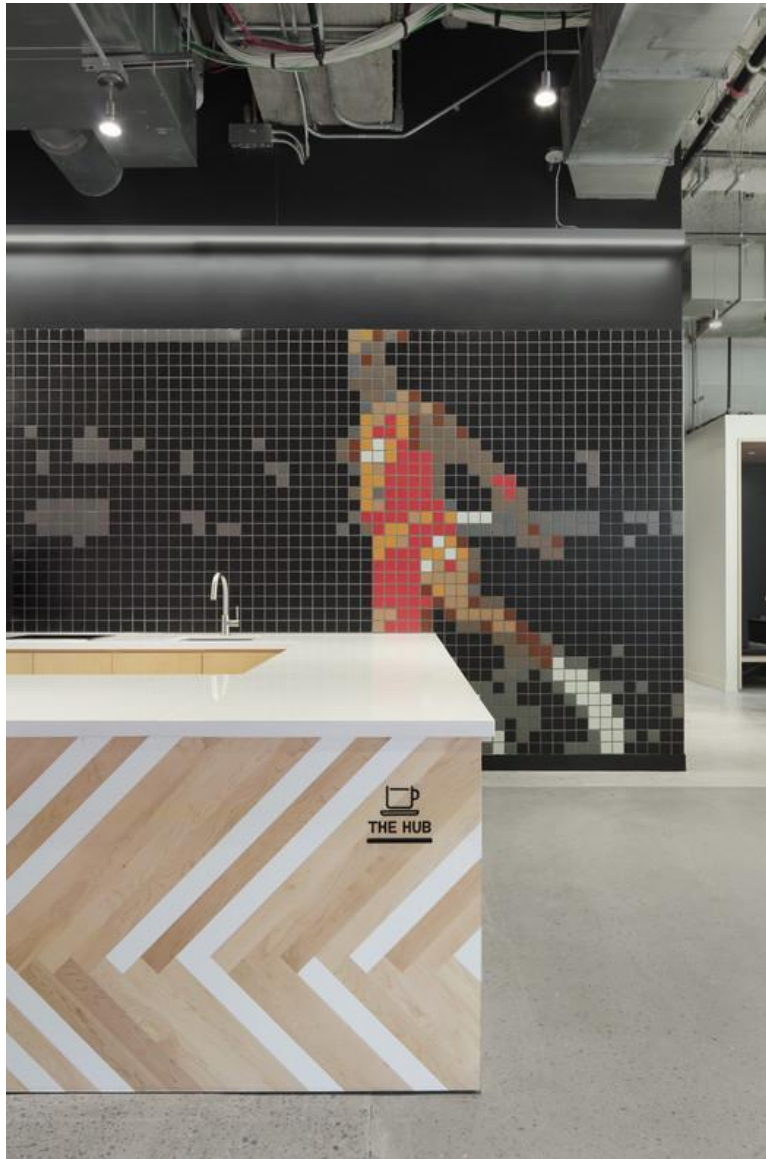

© Floto+Warner

The six floor 150,000 square foot space includes a massive indoor basketball court, varied workspaces, a hand-tagged food truck, VIP and workout spaces, a Nike heritage inspired VW van, and a 90-foot long sedum planted Swoosh on the rooftop terrace.



© Floto+Warner

The main directive—architecturally and graphically—was to highlight the synergy between New York City and Nike, by examining sport themed floors through the lens of NYC. The direction is manifested through materials, imagery, illustration, custom typography and space.



© Floto+Warner

Nike's Workplace Design + Connectivity (WD+C) team partnered with STUDIOS Architecture to complete the architecture, while Michael Spoljaric (Senior Creative Director, Nike Global Basketball) worked closely with long-time collaborators WeShouldDoItAll (WSDIA) and a roster of talents to implement all environmental branding components in the space.





© Floto+Warner

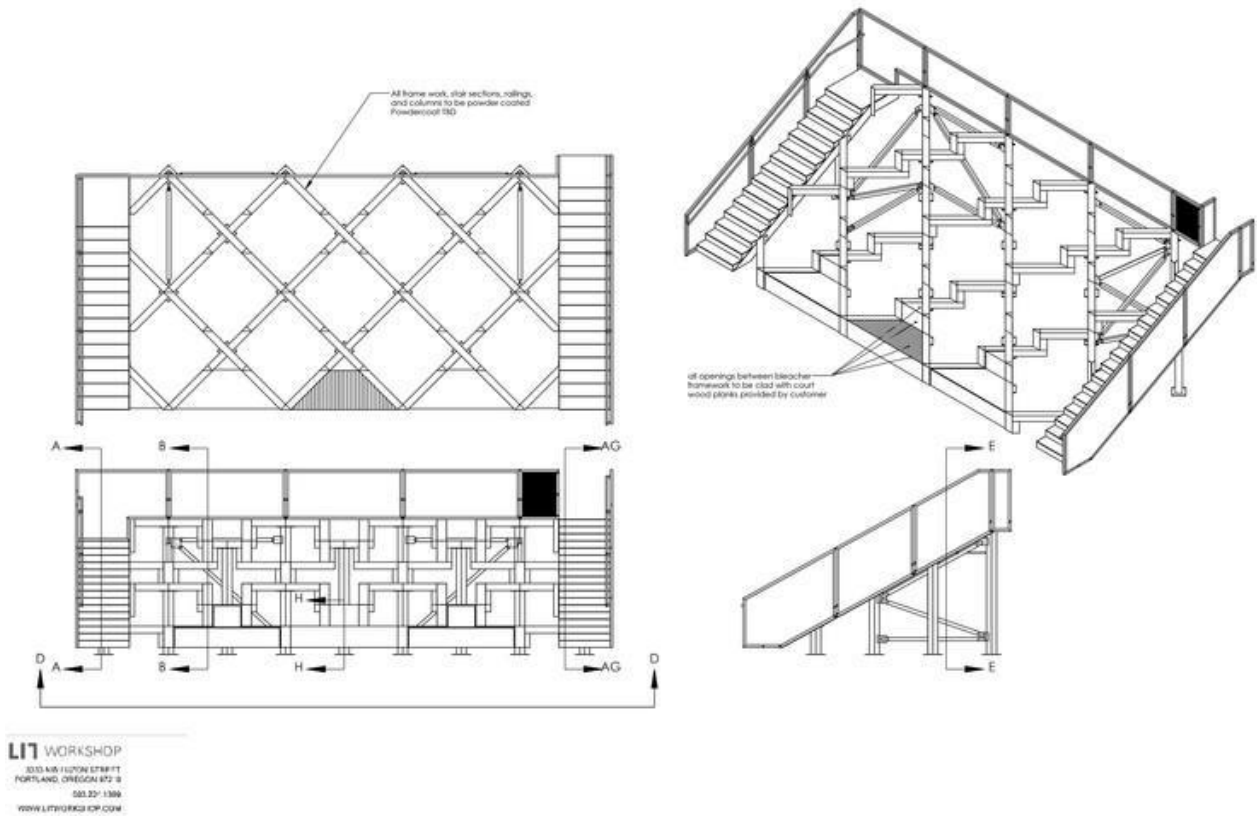

Bleachers Details and Plans



© Floto+Warner

Working closely with Spoljaric for over a year, WSDIA designed the indoor basketball court bleachers, all wayfinding and signage—featuring a custom typeface made exclusively for space—and numerous distinct branding moments.



© Floto+Warner

Notable pieces include: a 30 foot tall bark wall that nods to Nike's Oregon roots; custom handmade rugs in various spaces, one of which—in the VIP Jeter Lounge—features all Yankees' championship years; floor patterns derived from court lines and NYC's bridges spill into the VIP Showrooms; custom running and basketball inspired CNC milled wall tiles; conference room ceiling tiles resembling shoe soles; a Michael Jordan mosaic tile wall; custom perforated locker patterns; and the art direction and curation of all illustration and photography for meeting booths.



© Floto+Warner



Saint-Gobain is not responsible for, and expressly disclaims liability for, damages of any kind arising out of use, reference to or reliance on any information contained on this site. No guarantee is given by Saint-Gobain that the information is correct, complete or up-to-date or will not infringe any copyright or other intellectual property right and Saint-Gobain does not endorse any of the information contained on this site. Although the ArchDaily website may provide links to other internet resources, including web sites, Saint-Gobain is not responsible for the accuracy or content of information in these sites. Links from the ArchDaily website to third-party sites do not constitute an endorsement by Saint-Gobain of the parties or their products or services.